

ENGLISH
ESPAÑOL

TRUPER[®] max

Manual

Cordless String Trimmer

Applies for:

Code	Model
102338	MAX-40D

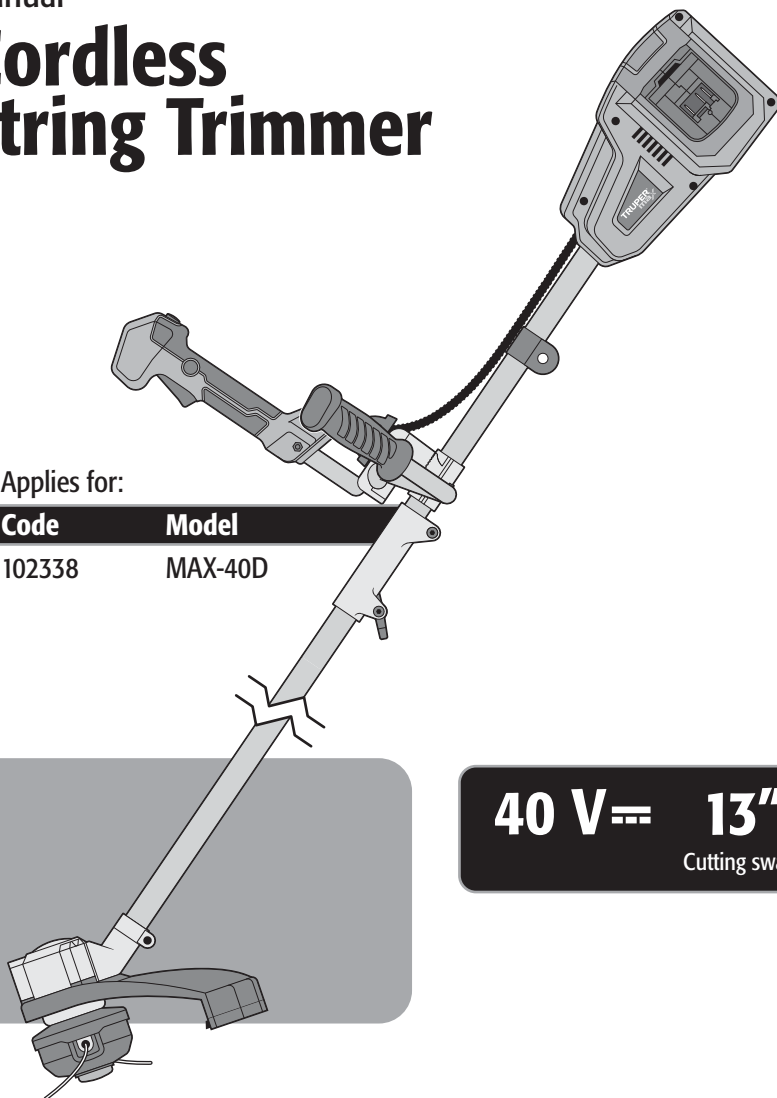



40 V₌₌ **13"**
Cutting swath

CAUTION



Read this manual thoroughly
before using the tool.



Technical data	3
Power requirements	3
 General power tool safety warnings	4
 Safety warnings for the use of cordless brush cutters	5
Parts list	7
Assembly	8
Parts	9
Preparations	10
Start up	11
Troubleshooting	13
Maintenance	13
Environmental protection	13
Accessories and spare parts	14
Notes	14
Authorized service centers	15
Warranty policy	16

CAUTION

To gain the best performance of the tool, prolong the duty life, make the warranty valid if necessary, and to avoid hazards of fatal injuries please read and understand this manual before using the tool.

Keep this manual for future references.

The illustrations in this manual are for reference only. They might be different from the real tool.

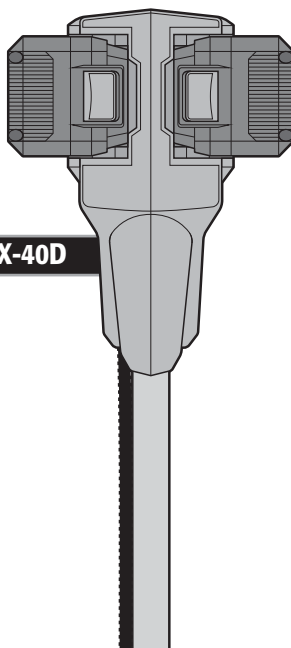

MAX-40D

Technical data

TRUPER®
max

MAX-40D

Code	102338
Description	Cordless string trimmer
Cutting capacity	13"
Voltage	40 V---
Speed	6 500 RPM
Weight with batteries	12 lb
Noise level	< 100 dB
Cutting systems	Nylon thread reel and blade
Recommended thread diameter	0.095"
Batteries	Ion-lithium 20 V--- 4 Ah Charging time: 1 h 20 min approximately
Charger	Input: Voltage: 127 V~ Output: 21.5 V--- 3 A Frequency: 60 Hz Current: 2 A

The power cable has cable clamps type: Y
The construction class of the tool is: Class III
Charger construction class is Reinforced insulation

⚠ WARNING Avoid the risk of electric shock or severe injury. When the power cable gets damaged it should only be replaced by the manufacturer or at a TRUPER Authorized Service Center.
The build quality of the electric insulation is altered if spills or liquid gets into the tool while in use.
Do not expose to rain, liquids and/or dampness.

⚠ WARNING Before gaining access to the terminals all power sources should be disconnected.



Power requirements

⚠ WARNING Tools with double insulation are equipped with a polarized plug (one prong is wider than the other). This plug will only fit in the right way into a polarized outlet. If the plug cannot be introduced into the outlet, reverse the plug. If it still doesn't fit, call a qualified electrician to install for you a polarized outlet. Do not alter the plug in any way. Double insulation eliminates the need of both a grounded third power cord with three prongs or a grounded power connection.

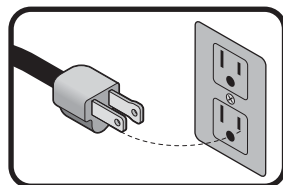

⚠ WARNING When using an extension cable, verify the gauge is enough for the power that your product needs. A lower gauge cable will cause voltage drop in the line, resulting in power loss and overheating. The following table shows the right size to use depending on cable's length and the ampere capability shown in the tool's nameplate. When in doubt use the next higher gauge.

Ampere Capacity	Number of Conductors	Extension gauge	
		from 6 ft to 49 ft	higher than 49 ft
from 0 A and up to 10 A	3 (one grounded)	18 AWG(*)	16 AWG
from 10 A and up to 13 A		16 AWG	14 AWG
from 13 A and up to 15 A		14 AWG	12 AWG
from 15 A and up to 20 A		8 AWG	6 AWG

* It is safe to use only if the extensions have a built-in artifact for over current protection.

AWG = American Wire Gauge. Reference: NMX-I-195-ANCE

⚠ WARNING When operating power tools outdoors, use a **⚡ VOLTECK** grounded extension cable labeled "For Outdoors Use". These extensions are especially designed for operating outdoors and reduce the risk of electric shock.





General power tools safety warnings



⚠ WARNING! Read carefully all safety warnings and instruction listed below. Failure to comply with any of these warnings may result in electric shock, fire and / or severe damage. **Save all warnings and instructions for future references.**

Work area

Keep your work area clean, and well lit.

Cluttered and dark areas may cause accidents.



Never use the tool in explosive atmospheres, such as in the presence of flammable liquids, gases or dust.

Sparks generated by power tools may ignite the flammable material.



Keep children and bystanders at a safe distance while operating the tool.

Distractions may cause losing control.



Electrical Safety

The tool plug must match the power outlet. Never modify the plug in any way. Do not use any adapter plugs with grounded power tools.

Modified plugs and different power outlets increase the risk of electric shock.



Avoid body contact with grounded surfaces, such as pipes, radiators, electric ranges and refrigerators.

The risk of electric shock increases if your body is grounded.

Do not expose the tool to rain or wet conditions.

Water entering into the tool increases the risk of electric shock.

Do not force the cord. Never use the cord to carry, lift or unplug the tool. Keep the cord away from heat, oil, sharp edges or moving parts.

Damaged or entangled cords increase the risk of electric shock.

When operating a tool outdoors, use an extension cord suitable for outdoor use.

Using an adequate outdoor extension cord reduces the risk of electric shock.

If operating the tool in a damp location cannot be avoided, use a ground fault circuit interrupter (GFCI) protected supply.

Using a GFCI reduces the risk of electric shock.

Personal safety

Stay alert, watch what you are doing and use common sense when operating a tool. Do not use a power tool while you are tired or under the influence of drugs, alcohol or medication.

A moment of distraction while operating the tool may result in personal injury.

Use personal protective equipment. Always wear eye protection.

Protective equipment such as safety glasses, anti-dust mask, non-skid shoes, hard hats and hearing protection used in the right conditions significantly reduce personal injury.



Prevent unintentional starting up. Ensure the switch is in the "OFF" position before connecting into the power source and / or battery as well as when carrying the tool.

Transporting power tools with the finger on the switch or connecting power tools with the switch in the "ON" position may cause accidents.

Remove any wrench or vice before turning the power tool on.

Wrenches or vices left attached to rotating parts of the tool may result in personal injury.

Do not overreach. Keep proper footing and balance at all times.

This enables a better control on the tool during unexpected situations.

Dress properly. Do not wear loose clothing or jewelry. Keep hair, clothes and gloves away from the moving parts.

Loose clothes, jewelry or long hair may get caught in moving parts.



If you have dust extraction and recollection devices connected onto the tool, inspect their connections and use them correctly.

Using these devices reduce dust-related risks.

Power Tools Use and Care

Do not force the tool. Use the adequate tool for your application.

The correct tool delivers a better and safer job at the rate for which it was designed.



Do not use the tool if the switch is not working properly.

Any power tool that cannot be turned ON or OFF is dangerous and should be repaired before operating.

Disconnect the tool from the power source and / or battery before making any adjustments, changing accessories or storing.

These measures reduce the risk of accidentally starting the tool.

Store tools out of the reach of children. Do not allow persons that are not familiar with the tool or its instructions to operate the tool.

Power tools are dangerous in the hands of untrained users.



Service the tool. Check the mobile parts are not misaligned or stuck. There should not be broken parts or other conditions that may affect its operation. Repair any damage before using the tool.

Most accidents are caused due to poor maintenance to the tools.



Keep the cutting accessories sharp and clean.

Cutting accessories in good working conditions are less likely to bind and are easier to control.

The machine must not be used by children or persons with reduced physical, sensory or mental capacities; nor by persons with no experience or knowledge in its use, unless they are supervised by a person responsible for their safety or have received prior instructions on the use of the machine.

Children must be supervised to ensure that they do not play with the machine.

Use the tool, components and accessories in accordance with these instructions and the projected way to use it for the type of tool when in adequate working conditions.

Using the tool for applications different from those it was designed for, could result in a hazardous situation.

Use and care of the battery-operated tool

Recharge only with the charger specified by TRUPER.

The charger specified for one battery may cause a fire hazard if used with another battery.

Use batteries specifically designed for the tool.

Use of any other battery may result in danger of fire damage.

When the battery is not in use, keep it away from any metallic object such as paper clips, coins, keys, nails, screws or any metallic object that can make a connection between the terminals.



A short circuit between the terminals can cause burns or fire.

In severe conditions, liquid may leak from the battery; avoid contact. If there is accidental contact, wash the area with water. In case of eye contact, seek medical attention.

Spilled liquid may cause irritation or burns.

Service

Repair the tool at an Authorized TRUPER Service Center using only identical replacement parts.

To maintain the safety of the tool.



This tool is in compliance with the Official Mexican Standard (NOM - Norma Oficial Mexicana).

Safety warnings for the use of cordless brush cutters

Batteries and charger

⚠ DANGER • Use only Truper Max chargers to charge the tool battery. Using any other charger may result in fire or risk of injury.

⚠ DANGER • Use only batteries designed specifically for the tool. Other batteries may create a risk of injury or fire.

• Connect the charger to an alternating current (AC) supply only.

⚠ DANGER • Do not use the charger outdoors.

• Observe “+/-” polarity when charging.

• Never recharge a leaking battery.

• Do not use batteries or the charger for purposes other than those for which they were designed.

• Do not modify the battery or charger contacts.

• Never expose the batteries to temperatures higher than 112 °F (50 °C).

⚠ DANGER • Never expose batteries to the fire, they may explode.

⚠ CAUTION • Batteries should be kept away from any metal objects such as paper clips, coins, keys, nails, screws or any other object that could cause the terminals to make contact, coins, keys, nails, screws or any other object that could cause the terminals to make contact, as this will cause a short circuit that could cause burns or fire.

⚠ CAUTION • Under extreme conditions, the battery liquid may leak. If so, avoid any contact. If accidental contact occurs, wash with abundant water, rinse with lemon juice and vinegar. If the liquid enters in contact with the eyes, wash with abundant water during several minutes and look for medical help immediately. The liquid expelled from the batteries could cause irradiation or burns.

⚠ CAUTION • To maximize battery life, fully discharge the battery at least once a month. Do not leave the battery without recharging for more than three months. Always charge the battery to its maximum capacity. Before using the machine for the first time, charge the battery for a minimum of 1 hour 20 minutes.

• Avoid overcharging the string trimmer while mowing to prevent damage to the battery.

Before using the string trimmer

⚠ CAUTION • Read the manual carefully. Familiarize yourself with the controls and proper use of the string trimmer.

• Wear eye protection.

• Never allow children or persons unfamiliar with the string trimmer to operate it.

• Avoid using the string trimmer while people, especially children or pets, are around.

• Use the string trimmer only in daylight or when there is good lighting.

• Start the engine only when hands and feet are away from the cutting elements.

• Never assemble metal cutting elements.

• Use only manufacturer's recommended replacement parts and accessories.

• Always disconnect the string trimmer batteries when not in use and before performing maintenance or cleaning.

• Inspect and service the equipment regularly. The equipment should only be serviced by an authorized service center.

• Be careful not to injure yourself with the knife to adjust the length of the nylon line.

• Keep the string trimmer out of the reach of children when not in use.

• Carefully inspect the area to be trimmed for any obstacles and remove foreign objects that may be thrown by the string trimmer. Failure to do so may result in an accident and reduce the life of the tool.

⚠ CAUTION • The area to be trimmed must be well lit.

⚠ CAUTION • Make sure that the string trimmer has all its parts in good condition and that the cutting line guard is properly installed. Do not use the string trimmer if the guard is damaged or parts are missing.

⚠ WARNING • Use only original nylon wire, and do not replace it with metal wire for any reason.

⚠ WARNING • To avoid electric shock, avoid working in humid environments, while it is raining and/or mowing dewy grass.



While using the string trimmer

⚠ CAUTION • Do not use the string trimmer near other people, children or animals.

⚠ WARNING • Never allow the cutting head to exceed 12" in height and do not point it at people or animals.

⚠ WARNING • Use the string trimmer to cut only at ground level, never use it to cut vegetation on stones or walls.

⚠ CAUTION • Do not walk on gravel floors with the string trimmer running, the cutting line can throw gravel fragments at the operator or others causing injury.

⚠ WARNING • Keep hands and feet away from the cutting head while the string trimmer is running.

⚠ DANGER • When working near roadways, stop cutting until there are no vehicles in sight. Foreign particles that may be thrown by the string trimmer into moving vehicles can cause a serious accident.

Security alerts



Read the manual before operating the machine.



Wear hearing protection and safety glasses.



Clear the area to be mowed of objects that could be thrown. Keep people and animals away from the mowing area.



Keep out of reach of children.



In the event of damage to the power cord, disconnect the plug immediately.



Do not expose to moisture.

After using the string trimmer

⚠ WARNING • The cutting elements continue to rotate after the engine is turned off.

• Do not attempt to stop the rotating motion of the cutting line in any way other than releasing the switch. Wait for the reel to stop by itself after turning the string trimmer off, this will take a few seconds.

Parts list

TRUPER®
max

1. Straight shaft and cutting head.
2. Bicycle type handle clamp and connection to the straight shaft.
3. Bicycle type handle.
4. Lithium ion battery (x2).
5. Cable clips (x2).
6. Dual battery charger.
7. Battery holder.
8. Pin rod.
9. Hexagonal wrench.
10. Cutting head for thread.
11. Cutting blade.
12. Guard.
13. Guard extension.
14. Receiving washer.
15. Clamping washer.
16. Cutting blade retainer.
17. Nut.
18. Shoulder harness.
19. Hex key.
20. Screw (x3).
21. Insulating gasket.
22. Steel washer

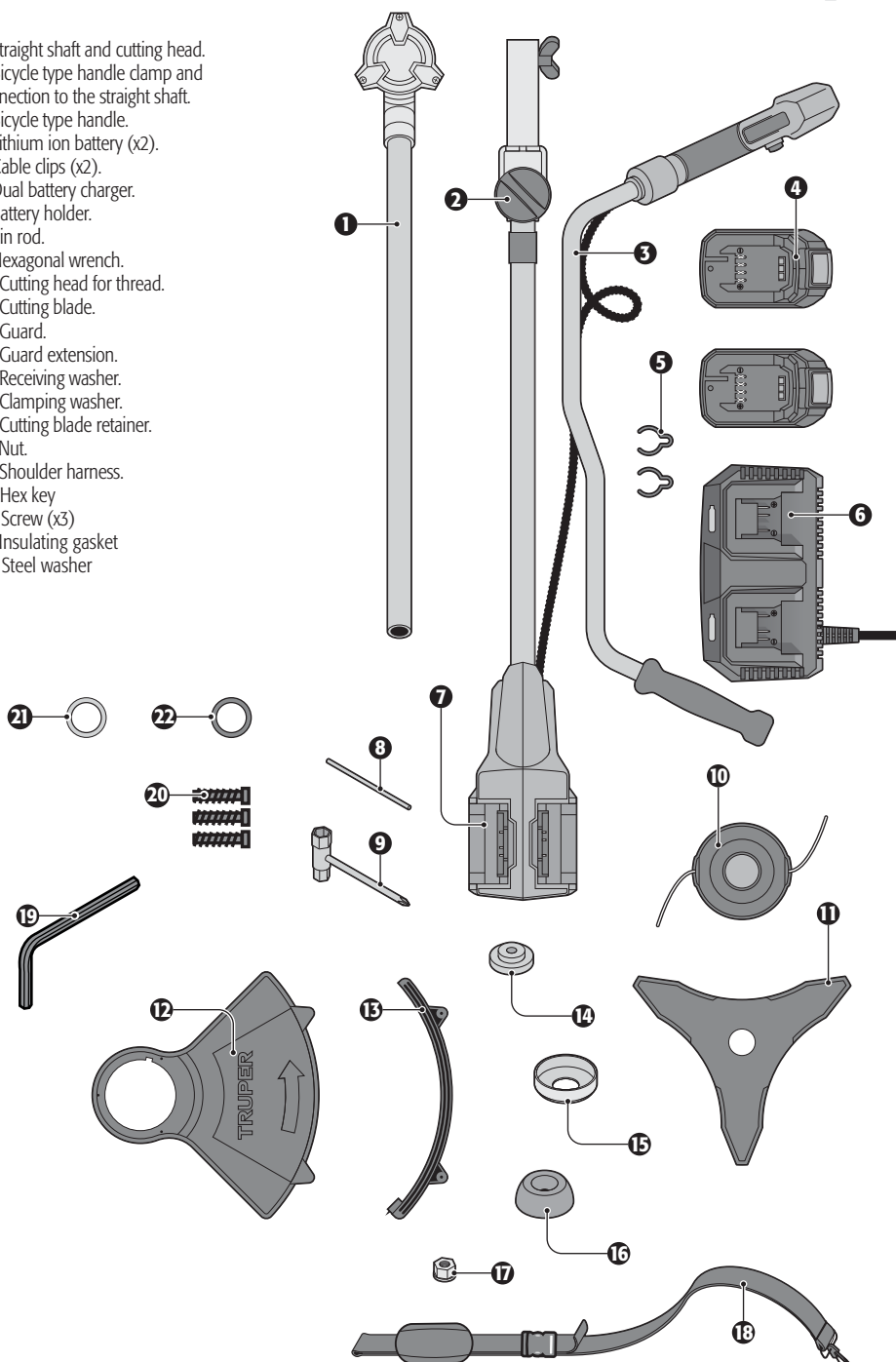

Bicycle type handle

- Loosen the knob (A) to open the clamp (B).
- Place the handle (C) on the clamp mount (D).
- Close clamp (B) and tighten knob (A) to secure in position.
- Secure the cable to the shaft with the supplied clips (E).

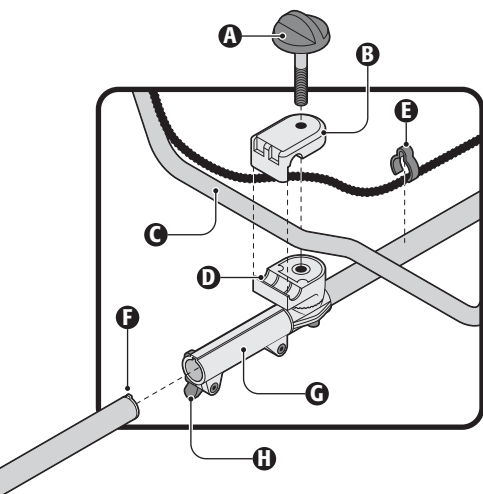

Straight shaft

- Match the notch in the straight shaft (F) with the slot in the mount hole (G).
- Insert the straight shaft into the mounting hole as far as it will go to make the electrical connection.
- Tighten the butterfly knob (H) to secure the straight shaft in place.

Bicycle type handle adjustment

- To adjust the bicycle type handle (C), loosen the knob (A), move the handle to the most comfortable position for the operator and tighten the knob.

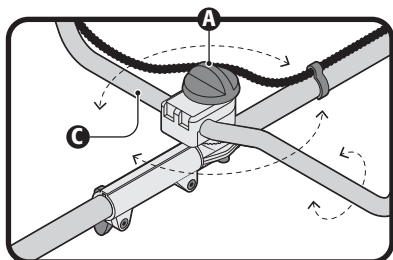

Guard

- Match the slot in the guard (I) with the notch in the cutting head (J).
- Secure the guard to the cutting head with the three screws provided.

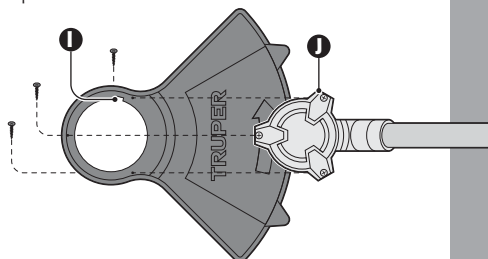

- When using the string trimmer with the string trimmer head (K), the guard extension (L) must be installed.
- Attach the extension to the guard by means of the two screws provided.

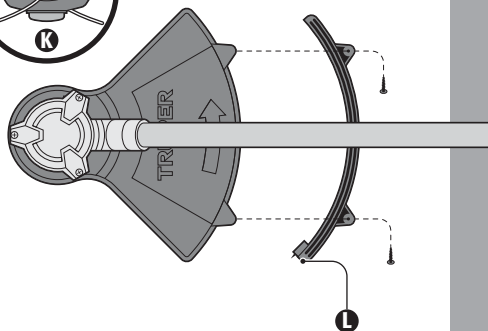

Harness

- Attach the harness latch to the axle eye.
- The eyelet has a screw to secure its position. Loosen the screw with the Allen wrench, run the eye along the shaft to the most comfortable position for the operator and then tighten the screw.

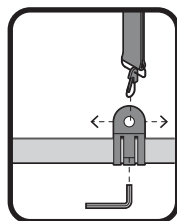

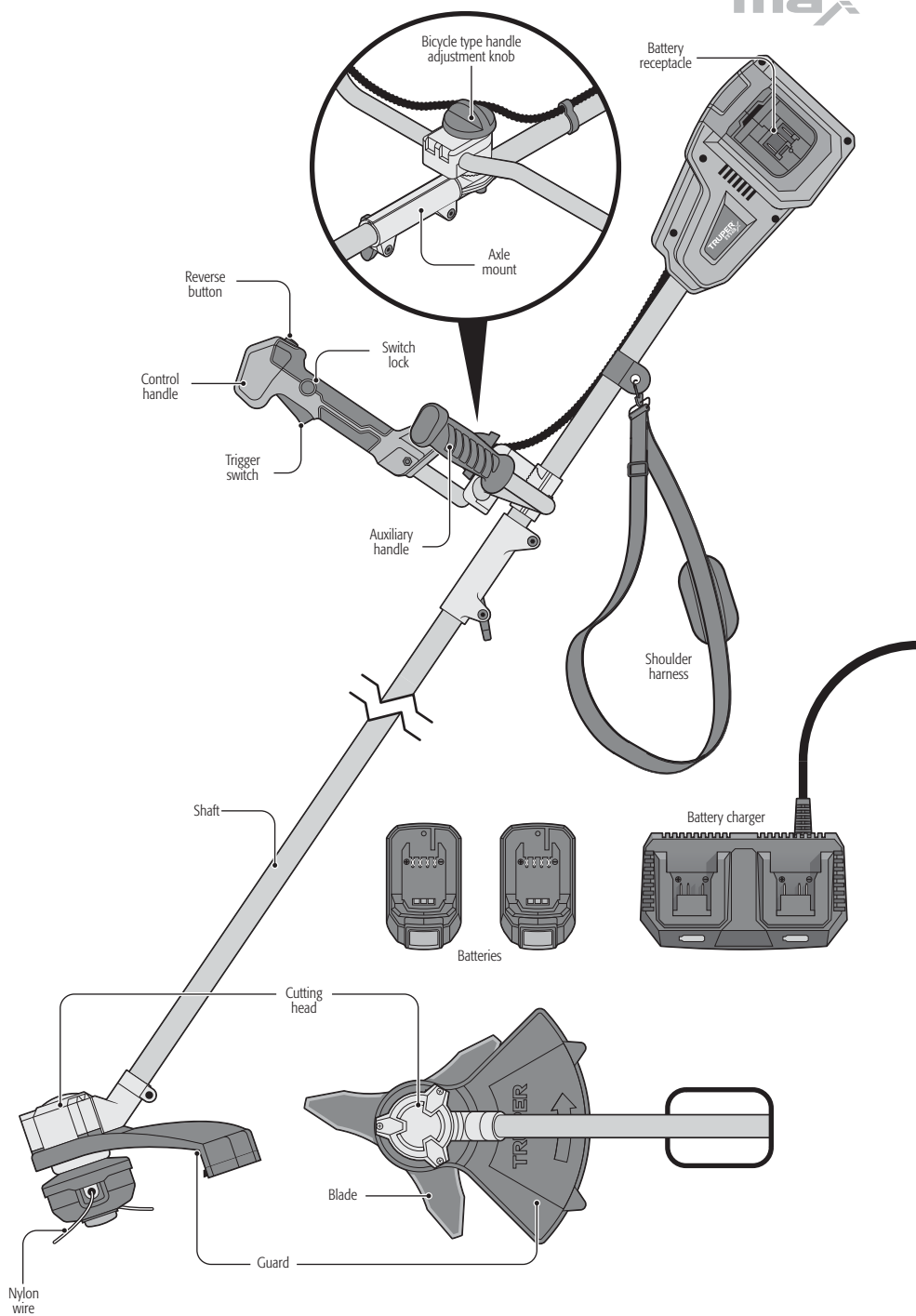

Installing the blade

- Insert the insulating gasket (A1) and steel washer (A2) into the cutting head shaft base (C).
- Place the receiving washer (B) in the spindle of the cutting head shaft (C).
- Align the blade (D) onto the receiving washer (B).
- Place the retaining plate (E) over the blade.
- Secure the blade by attaching the lock nut (F).
- Insert the locking pin (G) into the side of the receiving washer (B) to hold the shaft in place, then tighten the lock nut counterclockwise using the provided wrench (H).
- Use the guard with the extension attached. Refer to the Guard section (page 8) for more details.

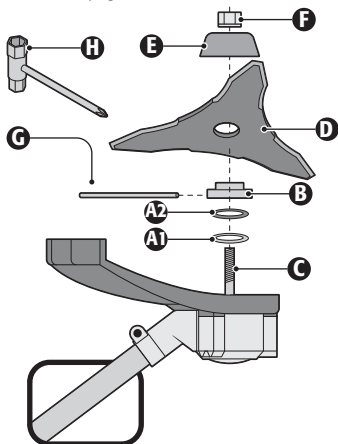

Installing the trimmer spool

- Place the insulating gasket (A1) and steel washer (A2) into the cutting head shaft base (C).
- Place the receiving washer (B) in the spindle of the cutting head shaft (C).
- Position the retaining washer (I) over the receiving washer (B).
- Insert the locking pin (G) into the side of the receiving washer (B) to secure the shaft.
- Screw the threaded spool (J) onto the shaft by hand, turning it counterclockwise to tighten.
- Use the guard with the extension attached. Refer to the Guard section (page 8) for more details.

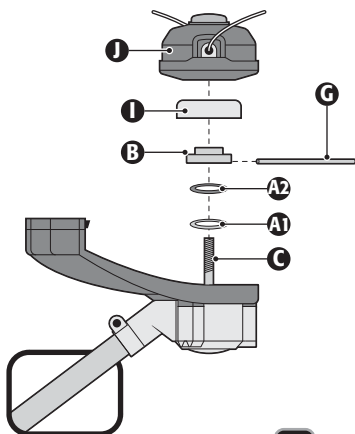

Battery charging

1. Plug the charger plug into a 127 V~ outlet. (The green charging indicator light will turn on).
 2. Insert the batteries into the charger by sliding it as shown in the picture. The green light should turn off and the red light should light up, indicating that charging has started.
- When the battery is fully charged, the green light will turn on and the red light will turn off.
 - Disconnect the charger from the power supply when charging is complete.
 - If the red light exceeds the recommended charging time, it is a sign that the battery is defective, replace it with a new one.
 - If the red-light flashes, it is a sign that the battery temperature is below 32 °F or above 167 °F. Wait until the battery temperature is in the proper range before charging.

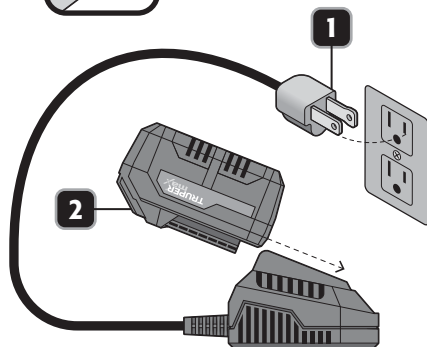

Considerations for battery use

The battery comes DISCHARGED from the factory. You will need to charge it for approximately 1 hour 20 minutes before you can use it. The normal charging temperature is 32 °F to 113 °F. Outside this range, charging is automatically suspended until it reaches the correct temperature. The normal discharge / working temperature is 32 °F to 167 °F. If 167 °F is exceeded, the electronic control shuts off the power to the tool until the temperature reaches the optimum temperature range again. When the battery is below normal voltage during work, the tool stops working. Between each charge, give the charger 15 minutes rest. In a hot environment or after prolonged use, the battery may become too hot to be recharged. Allow the battery to cool before attempting to recharge.

Preparations

TRUPER[®]
max

Batteries

- Once the batteries are charged, insert them into their respective receptacles.
- Slide the battery into its receptacle until you hear a click to make sure they are correctly inserted.
- To remove the batteries, press the latch (A) and slide the battery out.
- To make sure the batteries are charged, press the indicator button (B) next to each battery. The color of the light indicates the charge level.

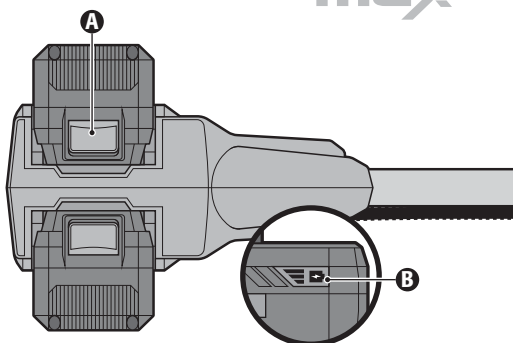

Tool/battery protection system

CAUTION • The tool is equipped with a system that automatically stops the tool to prolong both its useful life and that of the batteries, this happens in the following cases:

Overload. When the tool is forced, the batteries consume abnormally high current levels. Suspend overexertion work and turn the tool back on.

Overheating. Let the tool and batteries cool before turning it back on.

Over-discharge. The batteries level is low. In this case, remove the batteries from the tool and charge them.

Remaining battery capacity

Indicator lamp

Illuminated

OFF

Green
Orange
Red

50% to 100%

Orange
Red

25% to 50%

Red

10% to 25%

NOTE: Depending on the conditions of use and ambient temperature, the indication may differ slightly from the actual capacity.

Start up

Turning on

- To start the string trimmer, hold down the switch lock (C) and pull the trigger switch (D).
- The switch lock (C) prevents accidental starting.
- To turn the string trimmer off, release the trigger switch (D).
- In case the blade gets stuck in the brush, release the switch trigger (D), press the reverse button (E) and pull the switch trigger again.

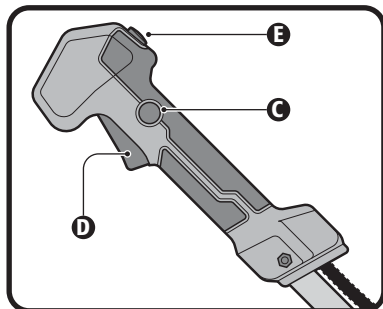

Operation

CAUTION • Remember that you as the string trimmer operator are responsible for your safety, as well as the safety of those in the vicinity of the work area. Follow all safety rules (pages 4 and 5) before operating the tool.

- Maintain a balanced stance with both feet firmly on the ground.
- Hold the string trimmer firmly in front of you with both hands so that the tool is in line with your body and pointing the cutting head 30° down, away from your feet.

DANGER • Do not start or operate the string trimmer in any other position.

- Start the string trimmer and make cuts from left to right by rotating your waist while maintaining the position of the tool.

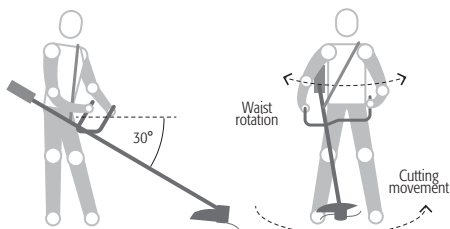

Cutting with cutting wire

- As the grass is cut, the cutting line will wear out and eventually come off. To release more line from the reel, push the string trimmer down a little so that the ground presses the retaining cap against the reel and releases more line. The excess string will be cut off by the guard blade, at this point stop pushing the string trimmer against the ground to avoid wasting string.
- When cutting tall weeds or grass, cut them gradually, do not try to cut them all at once from the base, as the residue may jam the cutting head or cause you to lose control of the string trimmer.

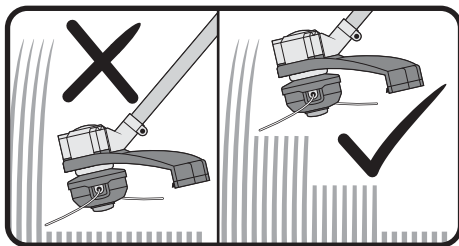

Cutting wire spool

- With the string trimmer off and the batteries removed, remove the reel retaining cap (A) by pressing the release buttons by hand.
 - Remove the empty spool, make sure it is clean and has no damaged or worn parts.
 - Cut a piece of thread 10 ft long.
 - Fold the thread in half, and insert it into the notch.
 - Take both threads and wind them in the direction of the arrow marked on the spool. Make sure that each piece of thread is twisted in its respective section (top and bottom).
- Do not tangle too much yarn, after tangling, there should be a minimum distance of 6 mm between the edge of the spool and the tangled thread.
- Leave approximately 6" of both untangled threads.
 - Place the spool back in its cover (H) by thread the ends of each thread through the holes in the cover.
 - Attach the retaining cap and push down until the two retaining latches click back.
 - Recommended for use with 2.4 mm diameter cutting wire model (HDU-12-95, HTA-95B, HTA-95, HLB-95, HTR3-95)

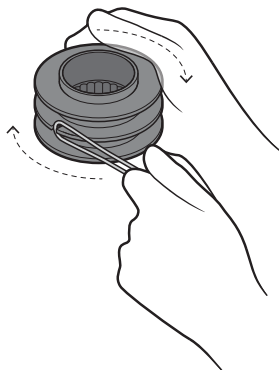
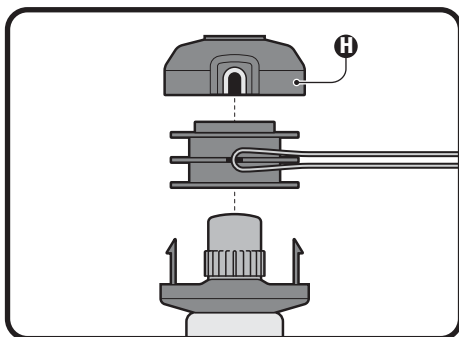
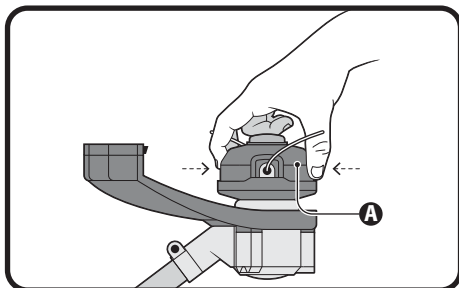

Troubleshooting

TRUPER®
max

Problem	Cause	Solution
String trimmer loses efficiency.	<ul style="list-style-type: none"> • Low battery. 	<ul style="list-style-type: none"> • Charge the battery.
Trigger cannot be pulled.	<ul style="list-style-type: none"> • The switch lock is locked. 	<ul style="list-style-type: none"> • Press the switch lock to unlock.
Trigger can be pulled but head will not rotate.	<ul style="list-style-type: none"> • The battery is not charged. 	<ul style="list-style-type: none"> • Charge the battery.
The battery is leaking.	<ul style="list-style-type: none"> • Tiny drips may occur in extreme temperatures or after heavy use, this is normal. • Heavy or very noticeable dripping is due to a damaged battery. 	<ul style="list-style-type: none"> • Immediately clean liquid from skin or clothing with soap and water. • Replace the battery immediately.
Battery does not charge and charge level indicator light does not turn on.	<ul style="list-style-type: none"> • Charger connection improperly installed on battery. • Incorrect charger connection to the socket. 	<ul style="list-style-type: none"> • Insert the charger connection to the battery correctly. • Check that the charger plug is properly connected to the socket.
The string trimmer heats up after prolonged periods of work.	<ul style="list-style-type: none"> • This heating is normal. 	<ul style="list-style-type: none"> • Allow the string trimmer to cool down for 5 minutes.
Battery heats up during operation.	<ul style="list-style-type: none"> • This heating is normal, as the energy extracted from the battery while the string trimmer is running causes the battery to heat up. 	<ul style="list-style-type: none"> • Stop the string trimmer for 5 minutes to allow the battery to cool down.
Battery heats up during charging.	<ul style="list-style-type: none"> • This heating is normal, resulting from the chemical reactions that occur inside the battery while it is charging. 	
Charger heats up during charging.	<ul style="list-style-type: none"> • This heating is normal, resulting from the voltage regulation. 	

Maintenance

Cleaning and care

- Regularly inspect all mounting screws and make sure that they are tightened correctly. If any of the screws are loose, tighten them immediately.
- Use a clean, soft cloth to clean the tool. Never use alcohol or detergent. Remove batteries from tool before cleaning.

Service

- Tool service should only be performed at TRUPER. Service and maintenance by unqualified persons can be dangerous and may result in personal injury and void the product warranty.

Environmental protection

Electrical appliances and batteries must not be disposed of with household waste. Please deliver this appliance and its batteries with the contacts insulated with adhesive cloth to a recycling center. Check the location of the nearest center in your community.

Notes

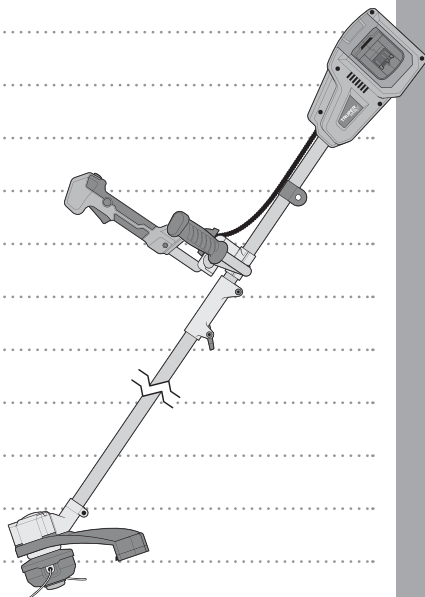

In the event of any problem contacting a TRUPER Authorized Service Center, please see our webpage www.truper.com to get an updated list, or call our toll-free numbers 800 690-6990 or 800 018-7873 to get information about the nearest Service Center.

AGUASCALIENTES **DE TODO PARA LA CONSTRUCCIÓN**
GRAL. BARRAGÁN #1201, COL. GREMIAL, C.P. 20030,
AGUASCALIENTES, AGS. TEL.: 449 994 0537

BAJA CALIFORNIA **SUCURSAL TIJUANA**
AV. LA ENCANTADA, LOTE #5, PARQUE INDUSTRIAL EL
FLORIDO II, C.P. 22244, TIJUANA, B.C.
TEL.: 664 969 5100

BAJA CALIFORNIA SUR **FIX FERRETERÍAS**
FELIPE ANGELES ESQ. RUIZ CORTÉZ S/N, COL. PUEBLO
NUEVO, C.P. 23670, CD. CONSTITUCIÓN, B.C.S.
TEL.: 613 132 1115

CAMPECHE **TORNILLERÍA Y FERRETERÍA AAA**
AV. ALVARO OBREGÓN #324, COL. ESPERANZA
C.P. 24080 CAMPECHE, CAMP. TEL.: 981 815 2808

CHIAPAS **FIX FERRETERÍAS**
AV. CENTRAL SUR #27, COL. CENTRO, C.P. 30700,
TAPACHULA, CHIS. TEL.: 962 118 4083

CHIHUAHUA **SUCURSAL CHIHUAHUA**
AV. SILVESTRE TERRAZAS #128-11, PARQUE INDUSTRIAL
BAFAR, CARRETERA MEXICO CUAUHTÉMOC, C.P. 31415,
CHIHUAHUA, CHIH. TEL.: 614 434 0052

MEXICO CITY **FIX FERRETERÍAS**
EL MONSTRUO DE CORREGIDORA, CORREGIDORA # 35,
COL. CENTRO, C.P. 06060, CUAUHTÉMOC, CDMX.
TEL.: 55 5522 5031 / 5522 4861

COAHUILA **SUCURSAL TORREÓN**
CALLE METAL MECÁNICA #280, PARQUE INDUSTRIAL
ORIENTE, C.P. 27278, TORREÓN, COAH.
TEL.: 871 209 68 23

COLIMA **BOMBAS Y MOTORES BYMATES DE MANZANILLO**
BLVD. MIGUEL DE LA MADRID #190, COL. 16 DE
SEPTIEMBRE, C.P. 28239, MANZANILLO, COL.
TEL.: 314 332 1986 / 332 8013

DURANGO **TORNILLOS ÁGUILA, S.A. DE C.V.**
MAZURIO #200, COL. LUIS ECHEVERRÍA, DURANGO,
DGO. TEL.: 618 817 1946 / 618 818 2844

ESTADO DE MÉXICO **SUCURSAL CENTRO JILOTEPEC**
PARQUE INDUSTRIAL # 1, COL. PARQUE INDUSTRIAL
JILOTEPEC, JILOTEPEC, EDO. DE MÉX. C.P. 54257
TEL.: 761 782 9101 EXT. 5728 Y 5102

GUANAJUATO **CÍA. FERRETERA NUEVO MUNDO S.A. DE C.V.**
AV. MEXICO - JAPON #225, CD. INDUSTRIAL, C.P. 38010,
CELAYA, GTO. TEL.: 461 617 7578 / 79 / 80 / 88

GUERRERO **CENTRO DE SERVICIO ECLIPSE**
CALLE PRINCIPAL MZ.1 LT. 1, COL. SANTA FE, C.P. 39010,
CHILPANCIÑO, GRO. TEL.: 747 478 5793

HIDALGO **FERREPRECIOS S.A. DE C.V.**
LIBERTAD ORIENTE #304 LOCAL 30, INTERIOR DE PASAJE
ROBLEDO, COL. CENTRO, C.P. 43600, TULANCINGO,
HGO. TEL.: 775 753 6615 / 775 753 6616

JALISCO **SUCURSAL GUADALAJARA**
AV. ADOLFO B. HORN # 6800, COL. SANTA CRUZ DEL
VALLE, C.P.: 45655, TLAJOMULCO DE ZUÑIGA, JAL.
TEL.: 33 3606 5285 AL 90

MICHOACÁN **FIX FERRETERÍAS**
AV. PASEO DE LA REPÚBLICA #3140-A, COL.
EX-HACIENDA DE LA HUERTA, C.P. 58050, MORELIA,
MICH. TEL.: 443 334 6858

MORELOS **FIX FERRETERÍAS**
CAPITÁN ANZURES #95, ESQ. JOSÉ PERDIZ, COL.
CENTRO, C.P. 62740, CUAUTLA, MOR.
TEL.: 735 352 8951

NAYARIT **HERRAMIENTAS DE TEPEC**
MAZATLAN #117, COL. CENTRO, C.P. 63000, TEPEC, NAY.
TEL.: 311 258 0540

NUEVO LEÓN **SUCURSAL MONTERREY**
CARRETERA LAREDO #300, 1B MONTERREY PARKS,
COLONIA PUERTA DE ANAHUAC, C.P. 66052, ESCOBEDO,
NUEVO LEÓN, TEL.: 81 8352 8791 / 81 8352 8790

OAXACA **FIX FERRETERÍAS**
AV. 20 DE NOVIEMBRE #910, COL. CENTRO, C.P. 68300,
TUXTEPEC, OAX. TEL.: 287 106 3092

PUEBLA **SUCURSAL PUEBLA**
AV. PERIFÉRICO #2-8, SAN LORENZO ALMECATLA,
C.P. 72710, CUAUTLACINGO, PUE.
TEL.: 222 282 8282 / 84 / 85 / 86

QUERÉTARO **ARU HERRAMIENTAS S.A. DE C.V.**
AV. PUERTO DE VERACRUZ #110, COL. RANCHO DE
ENMEDIO, C.P. 76842, SAN JUAN DEL RÍO, QRO.
TEL.: 427 268 4544

QUINTANA ROO **FIX FERRETERÍAS**
CARRETERA FEDERAL MZ. 46 LT. 3 LOCAL 2, COL. EJIDAL,
C.P. 77710 PLAYA DEL CARMEN, Q.R.
TEL.: 984 267 3140

SAN LUIS POTOSÍ **FIX FERRETERÍAS**
AV. UNIVERSIDAD #1850, COL. EL PASEO, C.P. 78320,
SAN LUIS POTOSÍ, S.L.P. TEL.: 444 822 4341

SINALOA **SUCURSAL CULIACÁN**
AV. JESÚS KUMATE SUR #4301, COL. HACIENDA DE LA
MORA, C.P. 80143, CULIACÁN, SIN.
TEL.: 667 173 9139 / 173 8400

SONORA **FIX FERRETERÍAS**
CALLE 5 DE FEBRERO #517, SUR LT. 25 MZ. 10, COL.
CENTRO, C.P. 85000, CD. OBREGÓN, SON.
TEL.: 644 413 2392

TABASCO **SUCURSAL VILLAHERMOSA**
CALLE HELIO LOTES 1, 2 Y 3 MZ. #1, COL. INDUSTRIAL,
2A ETAPA, C.P. 86010, VILLAHERMOSA, TAB.
TEL.: 993 353 7444

TAMAULIPAS **VM ORINGS Y REFACCIONES**
CALLE ROSITA #527 ENTRE 20 DE NOVIEMBRE Y GRAL.
RODRÍGUEZ, FRACC. REYNOSA, C.P. 88780, REYNOSA,
TAMS. TEL.: 899 926 7552

TLAXCALA **SERVICIOS Y HERRAMIENTAS INDUSTRIALES**
PABLO SIDAR #132, COL. BARRIO DE SAN BARTOLOMÉ,
C.P. 90970, SAN PABLO DEL MONTE, TLAX.
TEL.: 222 271 7502

VERACRUZ **LA CASA DISTRIBUIDORA TRUPER**
BLVD. PRIMAVERA ESQ. HORTENSIA S/N, COL.
PRIMAVERA C.P. 93308, POZA RICA, VER.
TEL.: 782 823 8100 / 826 8484

YUCATÁN **SUCURSAL MÉRIDA**
CALLE 33 #600 Y 602, LOCALIDAD ITZINCAB Y MULSAV,
MPIO. UMAN, C.P. 97390, MÉRIDA, YUC.
TEL.: 999 912 2451

Code	Model	Brand
102338	MAX-40D	TRUPER® max

Warranty. Duration: 5 year. Coverage: parts, components and workmanship against manufacturing or operating defects, except if used under conditions other than normal; when it was not operated in accordance with the instructive; was altered or repaired by personnel not authorized by TRUPER®. To make the warranty valid, only present the product in the establishment where you bought it or in Corregidora 35, Centro, Cuauhtémoc, CDMX, 06060, where you can also purchase parts, components, consumables and accessories. The costs of transportation of the product that derive from its fulfillment of its service network are included. TRUPER will not require any proof of purchase to make the warranty effective. Phone number 800-018-7873. Made in China. Imported by TRUPER, S.A. de C.V. Parque Industrial 1, Parque Industrial Jilotepec, Jilotepec, Edo. de Méx. C.P. 54257, Phone number 761 782 9100.



Stamp of the business. Delivery date: